

CEILING HT. 10'-9"
BEAM HT. 9'-3"

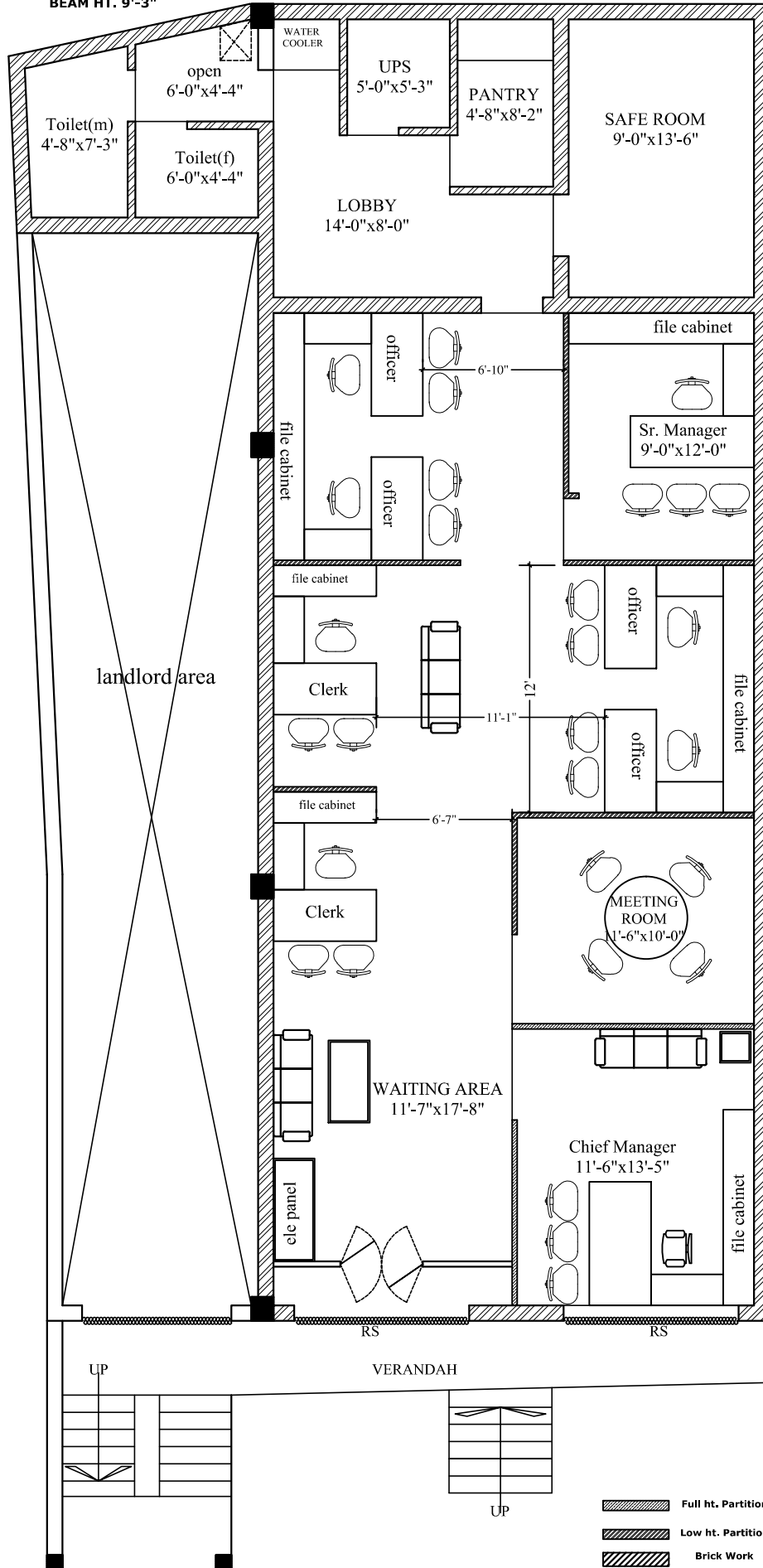

Full ht. Partition
Low ht. Partition
Brick Work

CARPET AREA - 1424.44 SQFT.

| | | | | |
|---|--|---|---|---|
| DWG TITLE :- PROPOSED INTERIOR LAYOUT SUB TITLE - UPPER GROUND FLOOR | DRG.No. 02 SCALE : N.T.S. DATE - 17-09-2020 REVISION - 2A DATE - 18/09/2020 ISSUED TO - | <p>DO NOT SCALE ANY DRG. FOLLOW WRITTEN DIMENSIONS ONLY. FOR ANY DISCREPANCY WITH RESPECT TO SITE PLEASE INFORM PROJECT MGR. FOR SEEKING CLARIFICATIONS FROM THE ARCHITECTS.</p> <p>THIS DRAWING IS THE PROPERTY OF ARCHITECT AND IS NOT TO BE REPRODUCED, COPIED, TRANSMITTED OR EMAIL TO THIRD PARTY WITHOUT APPROVAL FROM ARCHITECT.</p> | NORTH DRAWN BY. CHECKED BY- AR.ARCHANA YADAV | AR.ARCHANA YADAV ARCHITECT/ENGINEER/INTERIOR DESIGNER VISHWAKARMA PLAZA G-17 SECTOR-16-B, AWAS VIKAS COLONY,SIKANDRA, AGRA, PH. NO.9319102421 e-mail-ar_archana_yadav@yahoo.co.in |
|---|--|---|---|---|